

State of Wyoming Corner Record

(In compliance with the **CORNER PERPETUATION AND FILING ACT**, Wyoming Statutes, 1997 Section 33-29-140 et. seq., and the Rules and Regulations of the Board of Professional Engineers and Professional Land Surveyors)

Reverse side of this form may be used if more space is needed.

Record of original survey and citation of source of historical information (if corner is lost or obliterated). Description of corner monumentation evidence found and/or monument and accessories established to perpetuate the location of this corner. Sketch of relative location of monument, accessories, and reference points with course and distance to adjacent corner(s) (if determined in this survey). Method and rationale for reestablishment of lost or obliterated corner.

LOCATION: East Quarter Corner of Section 31, T14N, R65W, 6th Principal Meridian, Laramie County.

RECORD: GLO - Set limestone 14" x 8" x 6"

1978 - R.L. Hudson found a granite stone with "1/4" scribed on west face and "M" set on east face. It was set by Malcolm D. Martin, former Laramie County Surveyor. He notes a distance of 2596.87' to the NE 31-T14N-R65W, 2664.76' to CTR 32-T14N-R65W, and 1348.55' to S1/16 31-T14N-R65W.

1993 - Doyle Abrahamson found a granite stone with "1/4" scribed on the west face and "M" scribed in the east face in a small mound of stones.

RECOVERED: 2019 - Westwood Professional Services found a 10" x 7" x 6" stone with "1/4" and "M" scribed and accompanied by a lone t-post and small mound.

RESET: Accepting location of the monument as the corner location.

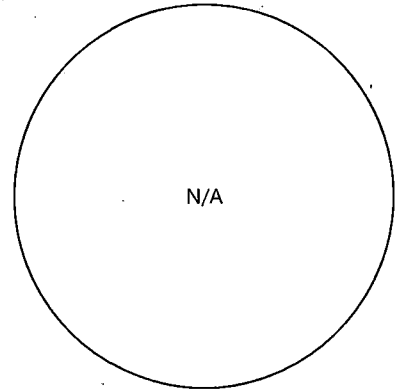

Monument Inscription

NE CORNER OF SECTION
31-14-65

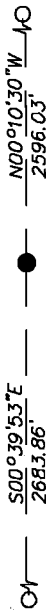

SE CORNER OF SECTION
31-14-65

Date of Field Work: 10/12/2019

Office Reference: 22237.02

Cross Index Plat

	1	2	3	4	5	6	7	8	9	10	11	12	13	14	15	16	17	18	19	20	21	22	23	24	25		
A																											A
B																											B
C																											C
D																											D
E																											E
F																											F
G																											G
H																											H
J																											J
K																											K
L																											L
M																											M
N																											N
O																											O
P																											P
Q																											Q
R																											R
S																											S
T																											T
U																											U
V																											V
W																											W
X																											X
Y																											Y
Z																											Z

Firm/Agency, Address

Westwood Professional Services
3701 12th St. N. Ste. 206
St. Cloud, MN 56303

This corner record was prepared by me or under my direction and supervision.

SEAL & SIGNATURE

Telephone Number: (320)-253-9495

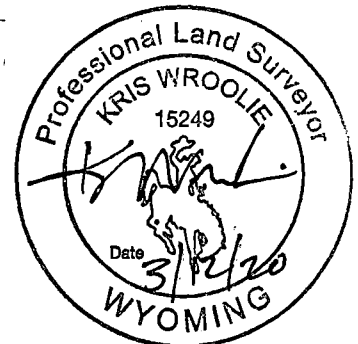

RECP #: 775852
RECORDED 4/15/2020 AT 10:17 AM BK# 2668 PG# 284
Debra K. Lee, CLERK OF LARAMIE COUNTY, WY PAGE 1 OF 1

Corner Name East Quarter Corner Section 31, T 14 N, R 65 W, 6th P.M. Cross-Index No.: X-5

County: Laramie Wyoming

SBRPEPLS/PLSW: March 1994; PLSW January 1998